



सुखे जगते जीवन्तु पोखते
 BDA
 R PLAN (1:100)

Building Plan Application No: MAP20180312142805107

Approved On 16 Mar 2018

Valid Till 15 Mar 2023

Approved By Surendra Kumar (Vice Chairman)

Examined By Amar Sahai (Junior Engineer), ASHEESH SHIVPURI (CTP), Surendra Prasad Singh (Secretary), ZAHEERUDDIN

SAIFI (Executive Engineer)

Plan Sanctioned under Self Approval Scheme provided in Building Bye-laws

Total Plot Area (sq.m.) : 360.00 Proposed Covered Area (sq.m.) : 349.45

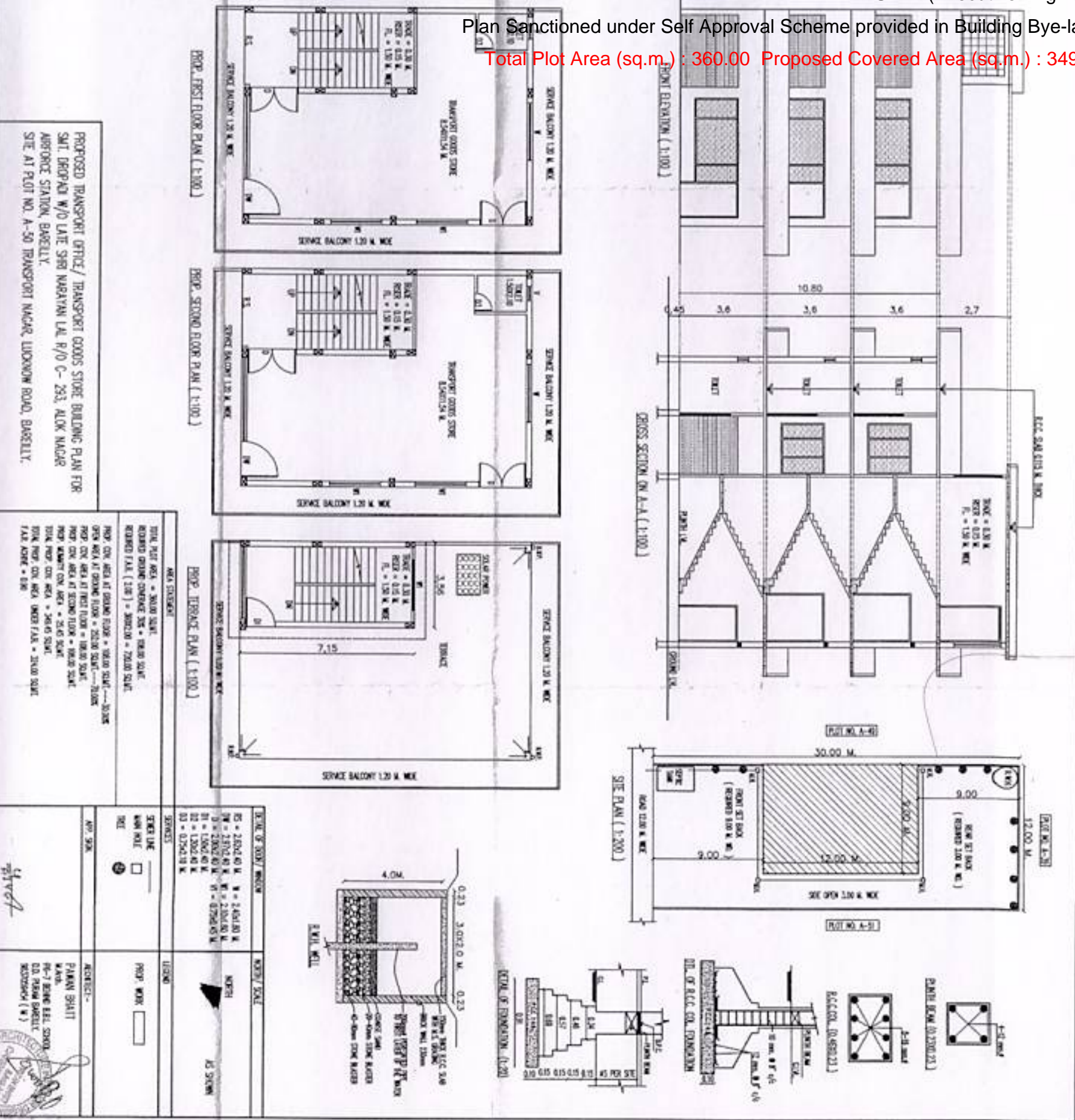

PROPOSED TRANSPORT OFFICE/ TRANSPORT GOODS STORE BUILDING PLAN FOR SMT. DROPA W/O LATE SHRI NARAYAN LAL R/O C-293, ALOK NAGAR AIRBORNE STATION, BARSELLY. SITE AT PLOT NO. A-50 TRANSPORT NAGAR, LUDHIANA ROAD, BARSELLY.

AREA SCHEDULE

TOTAL PLOT AREA = 360.00 SQ.M.
RESERVED DRIVING CHANNEL 30M = 78.00 SQ.M.
RESERVED F.A.S. (1.5M) = 30.00 SQ.M.
RESERVED F.A.S. (7.5M) = 70.00 SQ.M.
PROP. ON AREA AT GROUND FLOOR = 349.45 SQ.M.
PROP. ON AREA AT FIRST FLOOR = 202.00 SQ.M.
PROP. ON AREA AT SECOND FLOOR = 188.00 SQ.M.
PROP. ON AREA AT TERRACE FLOOR = 59.45 SQ.M.
TOTAL PROP. ON AREA UNDER F.A.S. = 202.00 SQ.M.
TOTAL PROP. ON AREA UNDER F.A.S. = 202.00 SQ.M.

TYPE OF DOOR/WINDOW	NO.	SIZE	AREA
DOOR	01	2.00 x 0.90 M	1.80
DOOR	02	2.00 x 0.90 M	1.80
DOOR	03	2.00 x 0.90 M	1.80
DOOR	04	2.00 x 0.90 M	1.80
DOOR	05	2.00 x 0.90 M	1.80
DOOR	06	2.00 x 0.90 M	1.80
DOOR	07	2.00 x 0.90 M	1.80
DOOR	08	2.00 x 0.90 M	1.80
DOOR	09	2.00 x 0.90 M	1.80
DOOR	10	2.00 x 0.90 M	1.80
DOOR	11	2.00 x 0.90 M	1.80
DOOR	12	2.00 x 0.90 M	1.80
DOOR	13	2.00 x 0.90 M	1.80
DOOR	14	2.00 x 0.90 M	1.80
DOOR	15	2.00 x 0.90 M	1.80
DOOR	16	2.00 x 0.90 M	1.80
DOOR	17	2.00 x 0.90 M	1.80
DOOR	18	2.00 x 0.90 M	1.80
DOOR	19	2.00 x 0.90 M	1.80
DOOR	20	2.00 x 0.90 M	1.80
DOOR	21	2.00 x 0.90 M	1.80
DOOR	22	2.00 x 0.90 M	1.80
DOOR	23	2.00 x 0.90 M	1.80
DOOR	24	2.00 x 0.90 M	1.80
DOOR	25	2.00 x 0.90 M	1.80
DOOR	26	2.00 x 0.90 M	1.80
DOOR	27	2.00 x 0.90 M	1.80
DOOR	28	2.00 x 0.90 M	1.80
DOOR	29	2.00 x 0.90 M	1.80
DOOR	30	2.00 x 0.90 M	1.80
DOOR	31	2.00 x 0.90 M	1.80
DOOR	32	2.00 x 0.90 M	1.80
DOOR	33	2.00 x 0.90 M	1.80
DOOR	34	2.00 x 0.90 M	1.80
DOOR	35	2.00 x 0.90 M	1.80
DOOR	36	2.00 x 0.90 M	1.80
DOOR	37	2.00 x 0.90 M	1.80
DOOR	38	2.00 x 0.90 M	1.80
DOOR	39	2.00 x 0.90 M	1.80
DOOR	40	2.00 x 0.90 M	1.80
DOOR	41	2.00 x 0.90 M	1.80
DOOR	42	2.00 x 0.90 M	1.80
DOOR	43	2.00 x 0.90 M	1.80
DOOR	44	2.00 x 0.90 M	1.80
DOOR	45	2.00 x 0.90 M	1.80
DOOR	46	2.00 x 0.90 M	1.80
DOOR	47	2.00 x 0.90 M	1.80
DOOR	48	2.00 x 0.90 M	1.80
DOOR	49	2.00 x 0.90 M	1.80
DOOR	50	2.00 x 0.90 M	1.80
DOOR	51	2.00 x 0.90 M	1.80
DOOR	52	2.00 x 0.90 M	1.80
DOOR	53	2.00 x 0.90 M	1.80
DOOR	54	2.00 x 0.90 M	1.80
DOOR	55	2.00 x 0.90 M	1.80
DOOR	56	2.00 x 0.90 M	1.80
DOOR	57	2.00 x 0.90 M	1.80
DOOR	58	2.00 x 0.90 M	1.80
DOOR	59	2.00 x 0.90 M	1.80
DOOR	60	2.00 x 0.90 M	1.80
DOOR	61	2.00 x 0.90 M	1.80
DOOR	62	2.00 x 0.90 M	1.80
DOOR	63	2.00 x 0.90 M	1.80
DOOR	64	2.00 x 0.90 M	1.80
DOOR	65	2.00 x 0.90 M	1.80
DOOR	66	2.00 x 0.90 M	1.80
DOOR	67	2.00 x 0.90 M	1.80
DOOR	68	2.00 x 0.90 M	1.80
DOOR	69	2.00 x 0.90 M	1.80
DOOR	70	2.00 x 0.90 M	1.80
DOOR	71	2.00 x 0.90 M	1.80
DOOR	72	2.00 x 0.90 M	1.80
DOOR	73	2.00 x 0.90 M	1.80
DOOR	74	2.00 x 0.90 M	1.80
DOOR	75	2.00 x 0.90 M	1.80
DOOR	76	2.00 x 0.90 M	1.80
DOOR	77	2.00 x 0.90 M	1.80
DOOR	78	2.00 x 0.90 M	1.80
DOOR	79	2.00 x 0.90 M	1.80
DOOR	80	2.00 x 0.90 M	1.80
DOOR	81	2.00 x 0.90 M	1.80
DOOR	82	2.00 x 0.90 M	1.80
DOOR	83	2.00 x 0.90 M	1.80
DOOR	84	2.00 x 0.90 M	1.80
DOOR	85	2.00 x 0.90 M	1.80
DOOR	86	2.00 x 0.90 M	1.80
DOOR	87	2.00 x 0.90 M	1.80
DOOR	88	2.00 x 0.90 M	1.80
DOOR	89	2.00 x 0.90 M	1.80
DOOR	90	2.00 x 0.90 M	1.80
DOOR	91	2.00 x 0.90 M	1.80
DOOR	92	2.00 x 0.90 M	1.80
DOOR	93	2.00 x 0.90 M	1.80
DOOR	94	2.00 x 0.90 M	1.80
DOOR	95	2.00 x 0.90 M	1.80
DOOR	96	2.00 x 0.90 M	1.80
DOOR	97	2.00 x 0.90 M	1.80
DOOR	98	2.00 x 0.90 M	1.80
DOOR	99	2.00 x 0.90 M	1.80
DOOR	100	2.00 x 0.90 M	1.80

APPROVED BY
 SURENDRA KUMAR
 VICE CHAIRMAN

APPROVED BY
 ASHEESH SHIVPURI
 CTP

APPROVED BY
 SURENDRA PRASAD SINGH
 SECRETARY

APPROVED BY
 ZAHEERUDDIN SAIFI
 EXECUTIVE ENGINEER

APPROVED BY
 AMAR SAHAI
 JUNIOR ENGINEER

APPROVED BY
 SURENDRA PRASAD SINGH
 SECRETARY

APPROVED BY
 ASHEESH SHIVPURI
 CTP

APPROVED BY
 SURENDRA KUMAR
 VICE CHAIRMAN